

INSTRUCTIONS

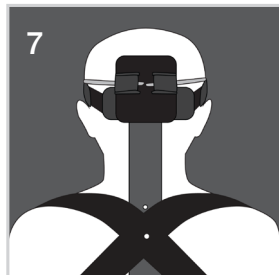
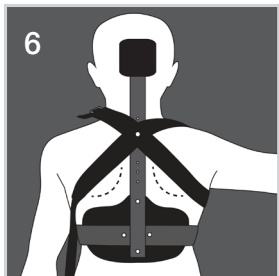
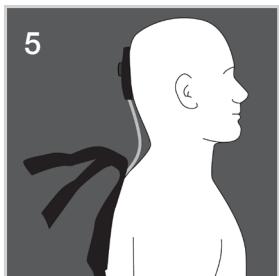
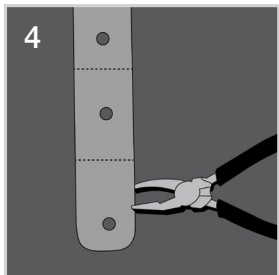
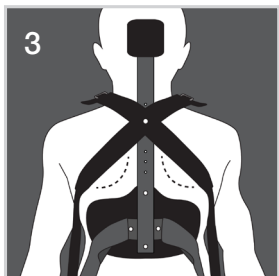
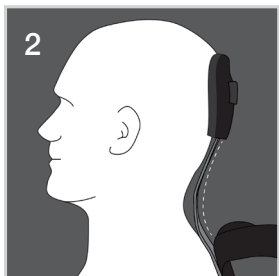
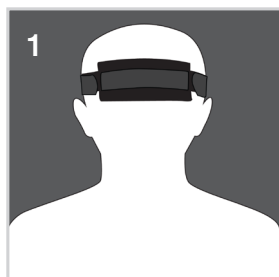

- 1** Apply headband with the foam side against the skin and hair, so that the wide section is centered posteriorly. **Figure 1**
 - Tighten to a comfortable snug fit, taking care to tighten both the left and right sides evenly.
- 2** The DCO should always be worn over a light T-shirt or undergarment and not directly against the skin.
- 3** Position the upright so that the center of the cranial rest pad is located at apex of the occiput. **Figure 2**
- 4** Check the location of the thoracic pad. Top trimline of pad should be located just below the most inferior angle of the scapula. **Figure 3**
 - If the location of thoracic pad needs to be changed, remove two Chicago screws from thoracic pad and relocate to proper height.
 - If metal upright extends below the inferior trimline of the thoracic pad, snap scored tab off, shortening the upright, using a pair of pliers or a small adjustable wrench. **Figure 4** Cover end of upright with the included vinyl cap.
 - Reattach thoracic pad to metal upright using two Chicago screws.
 - It will likely be required that you contour the upright to match the natural curve of the thoracic and cervical spine to achieve the proper angle for the cranial rest pad.
 - Contouring of the upright can be done over a chair-back or using contouring irons.
- 5** Attach the encircling strap around the torso (at lower rib level) and adjust tension to a snug level, adequate to hold the DCO in place while adjusting the shoulder straps. **Figure 5**
- 6** Attach shoulder straps, one at a time. Tension the straps to a snug tightness when the arm is fully extended and abducted. **Figure 6**
 - Check tension with arm down at the side to ensure that the straps are not over-tightened.
- 7** Check the tension of the encircling strap around the chest and make any adjustments necessary.
- 8** Attach the remaining loose side of the elastic bands to the spring hooks attached to the headband. **Figure 7**
 - If any minor adjustment is needed to the tension of the elastic bands, adjustment can be made by releasing the cam buckles on the back of the posterior cranial rest pad and sliding the strap to increase or decrease tension.

FOR TECHNICAL SUPPORT CONTACT SURESTEP THE EXCLUSIVE DISTRIBUTOR OF THE DCO

Return Policy

SureStep will accept returns for this product in its original condition within 10 days of the purchase date. Modified or damaged products will not be accepted. Products are inspected upon return. Refunds or credit will not be issued for products that have been:

- Altered or modified in any way (this includes contoured uprights)
- Damaged or broken
- Permanent adjustments made to straps or headband

Exchange Policy

We understand that not every product will fit perfectly and you may need to exchange your purchase for a different size. We will exchange your product at no charge due to sizing issues within 10 days of the purchase date. Complete the provided exchange form and send it back with the product.

Defective Merchandise

If the product is not functioning properly due to a manufacturer's defect, we will repair the product for you at no charge within 30 days from the date of purchase.